

Recycle



If your device is no longer functional, please note that disposal with household waste is not permitted. To protect the environment, it must be handed over to an authorized device recycling center for recycling. Please take your device to a specialized WEEE collection point for this purpose.

The European Directive 2012/19/EU on the recycling of waste electrical and electronic equipment (WEEE) stipulates that household appliances must not be disposed of with other household waste.

Separate collection is required to ensure recycling and protect the environment. Please contact your local waste disposal service or another operator specialized in the collection of waste electrical and electronic equipment.

CE The device complies with European Directives 2014/35/EU (LVD – Low Voltage Directive) and 2014/30/EU (EMC – Electromagnetic compatibility).



Download our free
recipe book.

Bolkani

AIR FRYER

Double Stack

GERMAN

Bolkani

Balkani e.k.
Raiffeisenstr. 3
30827 Garbsen, Germany
service@Bolkani.com
WEEE Reg. No. DE 81026679



Download our free
recipe book.

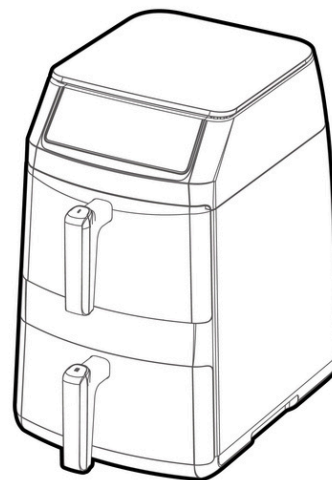

MODEL NO.: AF1102T

220-240V 50/60Hz 2500W

IMPORTANT SAFETY INSTRUCTIONS

FOR HOUSEHOLD USE ONLY. READ ALL INSTRUCTIONS BEFORE USE.

- Read and review the instructions to understand the operation and use of the product.
- This symbol indicates a hazard which, if the associated warning is ignored, could result in personal injury, death or substantial property damage.
- Avoid contact with hot surfaces. Always wear hand protection to prevent burns.

Warning:

Failure to follow these instructions may result in electric shock, fire, or burns, which could result in property damage, injury, or death. When using electrical appliances, basic safety precautions should always be followed, including the following:

- This device may only be used by persons with reduced physical, sensory or mental capabilities or lack of experience and knowledge if they have been given supervision or instruction concerning use of the device in a safe way and understand the hazards involved.
- Keep the device and its cord out of reach of children. Do NOT allow children to use the device. Careful supervision is required when the device is used near children.
- Do not allow children to play with the device.
- Do not place or store anything on the device while it is in operation.
- To avoid fire, DO NOT place the appliance on or near a gas or electric stove or in a heated oven.
- NEVER use an electrical outlet under the countertop.
- NEVER connect this unit to an external timer or separate remote control system.
- DO NOT use an extension cord. A short power cord reduces the risk of children under 8 reaching or becoming entangled in the cord and reduces the risk of tripping over longer cords.

- To protect against electric shock, DO NOT immerse the cord, plug, or appliance casing in water or any other liquid. Cook only in the provided basket.
- Check the appliance and power cord regularly. DO NOT use the appliance if the power cord or plug is damaged. If the appliance malfunctions or is damaged, stop use immediately and contact the customer service department. The appliance must be replaced by the manufacturer, its customer service department, or a similarly qualified person to avoid a hazard.
- Always assemble the device properly before use.
- DO NOT cover the air inlet and outlet during operation. This will prevent even cooking and may cause damage or overheating of the appliance.
- Before inserting the removable basket into the appliance, ensure that the basket and appliance are clean and dry. Wipe them with a soft cloth.
- This device is intended for household use only. Use the device only for its intended purpose. Do not use in moving vehicles or boats. Do not use outdoors. Misuse may result in injury.
- The appliance is intended for countertop use only. Ensure the surface is level, clean, and dry. Do NOT move the appliance while in use.
- DO NOT place the appliance near the edge of a countertop while in operation.
- DO NOT use accessories that are not recommended or sold by the manufacturer. Do not place accessories in a microwave, toaster oven, convection oven, conventional oven, or on a ceramic cooktop, electric heating element, gas stove, or barbecue grill. Using accessories that are not recommended may result in fire, electric shock, or personal injury.
- ALWAYS make sure the basket is properly closed before use.
- DO NOT use the appliance without the removable basket.
- DO NOT use this appliance for deep frying.

- Avoid contact of food with the heating elements. DO NOT overfill the appliance during cooking. Overfilling may cause injury or property damage, or impair the safe use of the appliance.
- Outlet voltage may vary and affect the performance of your product. To prevent potential illness, use a thermometer to check that your food has reached the recommended temperatures.
- If the appliance emits black smoke, unplug it immediately. Wait until the smoke has stopped before removing any cooking utensils.
- Do not touch hot surfaces. The appliance surfaces will be hot during and after use. To avoid burns or injury, ALWAYS use protective pot holders or insulated pot holders and use the provided handles.
- Be extremely careful when hot food is in the appliance. Improper use may result in injury.
- Spilled food can cause severe burns. Keep the appliance and cord away from children. Do NOT let the cord dangle over table or counter edges or touch hot surfaces.
- The basket and crisper plate become very hot during cooking. Avoid physical contact when removing the basket or plate from the appliance. ALWAYS place the basket or plate on a heat-resistant surface after removing it. DO NOT touch any accessories during or immediately after cooking.
- Cleaning and maintenance must not be carried out by children.
- To unplug the unit, turn off all controls and then unplug the unit from the electrical outlet when not in use and before cleaning. Allow the unit to cool before cleaning, disassembling, inserting or removing parts, and storing.
- **DO NOT clean with metal sponges. Pieces may break off the sponge and touch electrical parts, creating a risk of electric shock.**
- For information on regular maintenance of the device, see the "Cleaning and Maintenance" section.
- **DO NOT place any of the following materials into the appliance: paper, cardboard, plastic, roasting bags, or similar items. These may cause fire.**
- Extreme caution should be exercised when using containers made of materials other than metal or glass.

- This appliance has a polarized plug (one blade is wider than the other). To reduce the risk of electric shock, this plug fits only one way into a polarized outlet. If the plug doesn't fit fully into the outlet, reverse the fit. If it still doesn't fit, consult a qualified electrician. Do not attempt to modify the plug in any way.
- An electronic version of this manual is available from our customer service.
- The power consumption of this model is 0.32 W in off mode, with no standby mode. The product will automatically turn off within 10 minutes of its functions being stopped.

KEEP THESE INSTRUCTIONS.



Schuko plug (Type F)



Sockets (Type F)

FOR YOU

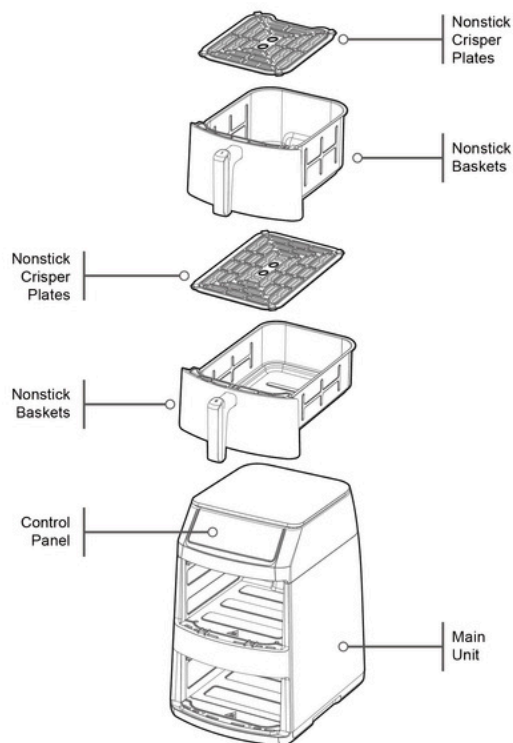

GET TO KNOW YOUR AIR FRYER!

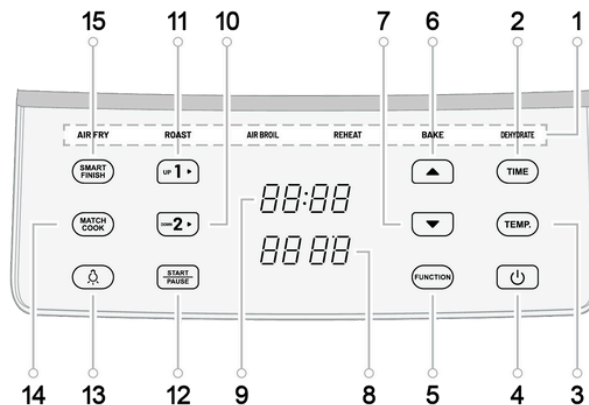

1. Function button	9. TIME indicator
2. TIME button	10. Lower basket button (Zone 2)
3. TEMP button	11. Upper basket button (Zone 1)
4. ON/OFF button	12. START/PAUSE button
5. Function button	13. Interior light button
6. TIME/TEMP increase button	14. MATCH COOK button
7. TIME/TEMP decrease button	15. SMART FINISH button
8. TEMP indicator	

FUNCTIONS

- **AIR FRY:** This function gives your food a crispy, crunchy crust—without using any oil. The combination of hot air, high fan speed, and the top heating element creates a variety of delicious and healthier dishes than traditional frying.
- **AIR BROIL/ROAST:** This function is suitable for beef, chicken, pork, fish, and more. Grilling is best for meat and fish, while conventional grilling should only be used to brown the surface. Add a crispy finishing touch to your dishes or melt toppings for the perfect finish.
- **ROAST/FRY:** Use the appliance as an oven for tender meat and more.
- **REHEAT:** Gently reheat leftovers for crispy results.
- **BAKE:** This function is suitable for roasting meat, including chicken, or delicate baked goods such as cakes and puddings. Create delicious pastries and desserts.
- **DEHYDRATE/DRY:** Dehydrate meat, fruits and vegetables for healthy snacks.

CONTROL BUTTONS

- **ON/OFF button:** This button turns the appliance on and off and stops all cooking functions.
- Upper basket button (Zone 1): Controls the power for the upper basket (Zone 1).
- Lower basket button (Zone 2): Controls the power for the lower basket (Zone 2).
- **TIME button:** Press the button and then or to set the cooking time before or during cooking.
- **TEMP button:** Press the button and then or to set the cooking temperature before or during cooking.



- **START/PAUSE button:** Once you have reached the desired cooking function, you can start the cooking process by pressing the button. Press the button again to pause the cooking process.
- **SMART FINISH button:** Automatically synchronizes cooking times to ensure both zones finish at the same time, even if they have different cooking times.
- **MATCH COOK button:** Automatically matches the settings of Zone 2 to those of Zone 1 to cook a larger quantity of the same food or to cook different foods using the same function, temperature and time.
- **Function button:** Use the function button to select a cooking function. The default temperature and timer setting for each selection are shown on the LED display.
- **Interior light button:** Pressing the corresponding basket button and pressing the button turns on the interior light.



BEFORE FIRST USE

- Remove and dispose of all packaging materials, promotional labels, and tape from the device.
- Remove all accessories from the packaging and read this manual carefully. Pay particular attention to the operating instructions, warnings, and important safety precautions to avoid injury or property damage.
- Clean the baskets and hot air plate in hot soapy water, then rinse and dry thoroughly. For a longer lifespan, we recommend hand washing. NEVER clean the appliance in the dishwasher.

COOKING IN YOUR AIR FRYER

SMART FINISH

To complete the cooking process at the same time when food has different cooking times, temperatures and/or functions:

1- Insert the hot air plate into the baskets, add the ingredients and insert the baskets into the appliance.

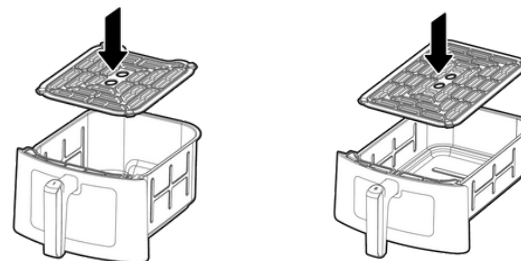

2- Press the button to select Zone 1 first. Press the button to select the

Select the desired cooking function. The default temperature and time are shown on the LED display.

Press the or button and then the or button to adjust the time and temperature.

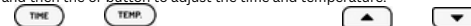

3- Press the button to select Zone 2. Press the button to select the desired cooking function.

The default temperature and time are displayed on the LED display. Press the button



or and then the or button to adjust the time and temperature.

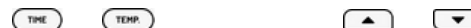

NOTE: You can select a different function for Zone 2.

1-First press the button, then the button to start cooking in the zone with the longest cooking time. The appliance will beep and activate the second zone when both zones have the same remaining cooking time.

2-When the cooking process is complete, the device beeps.

3-Remove the ingredients by tipping them out or using tongs or a silicone-tipped utensil. Do not place the baskets on top of the appliance.

MATCH COOK

To cook the same food:

1-Place the hot air plate in the baskets, add the ingredients and insert the baskets into the appliance.

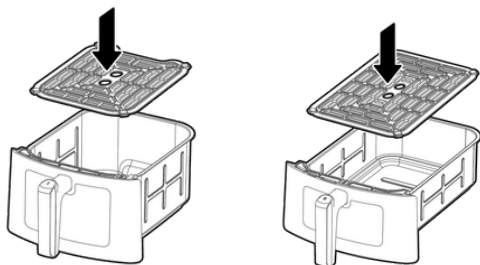

2-Press the button. The Zone 1 and Zone 2 buttons will flash. Press the button to select the desired cooking function. The default temperature and time will appear on the LED display. Press the TIME/TEMP button, then or to adjust the time and temperature.

3-Press the button to start cooking for both zones.

4-When the cooking process is complete, a beep will sound.

5-Remove the ingredients by pouring them out or using tongs/silicone-tipped utensils. Do NOT place baskets on top of the appliance.

Start both zones at the same time but end at different times:

1- Insert the hot air plate into the baskets, add the ingredients and insert the baskets into the appliance.

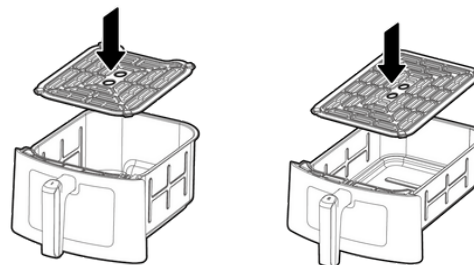

2-Press the button to select Zone 1 first. Press the button to select the desired cooking function. The default temperature and time will appear on the LED display. Press the or button, then the or button to adjust the time and temperature.

3-Press the button to select Zone 2 and repeat step 2.

4-Press the button to start cooking in both zones.

5-When cooking is complete, a beep will sound.

6-Remove ingredients by pouring them out or using tongs/silicone-tipped utensils. DO NOT place baskets on the appliance.

COOKING IN A SINGLE ZONE/BASKET

Funktion	Standardtemperatur	Temperaturbereich	Standardzeit	Zeitbereich
Air Fry hot air frying	200°C	150°C-200°C	20min	1min-1 Std
Air Broil Heissluftgrille	220°C	175°C-220°C	10min	1min-1 Std
Roast	200°C	120°C-200°C	15min	1min-1 Std
Reheat warm-up	175°C	150°C-200°C	35min	1min-1 Std
Bake Baking	175°C	120°C-200°C	15min	1min-1 Std
Dehydrate the Door	65°C	30°C-90°C	60min	30min-24 Std

To turn on the device, plug the power cord into a power outlet and press the power button.

AIR FRY/HOT AIR FRYING

1- Place a hot air plate in a basket, add the ingredients and insert the basket into the appliance.

2- Select Zone 1 (you can also select Zone 2). Press the button to select "Air Fry." The default temperature and time will appear on the LED display. Press the or button, then the or button to adjust the time and temperature.

3- Press the button to start cooking.

4- Halfway through the cooking time, a beep will sound to remind you to remove the basket and shake or turn the ingredients.

5- When the cooking process is complete, a beep will sound.

6- Remove the ingredients by pouring them out or using tongs/silicone-tipped utensils. Do NOT place the baskets on top of the appliance.

ROAST

1-Place a hot air plate in a basket, add the ingredients and insert the basket into the appliance.

2-Select Zone 1 (you can also select Zone 2). Press the button to select "Roast." The default temperature and time will appear on the LED display. Press the or button, then the or button to adjust the time and temperature.

3-Press the button to start cooking.

4-Halfway through the cooking time, the appliance will beep to remind you to remove the basket and turn the ingredients.

5-When the cooking process is complete, the appliance beeps.

6-Remove the ingredients by tipping them out of the appliance or using tongs/silicone-tipped utensils. Do NOT place the baskets on top of the appliance.

AIR BROIL/HEISSLUFTGRILLEN

1-Place a hot air plate in a basket, put the ingredients inside and insert the basket into the appliance.

2-Select Zone 1 (you can also select Zone 2). Press the button to select Air Broil. The default temperature and time will appear on the LED display. Press the or button, then the or button to adjust the time and temperature.

3-Press the button to start cooking.

4-Halfway through the cooking time, the appliance will beep to remind you to remove the basket and turn the ingredients.

5-When the cooking process is complete, the appliance beeps.

6-Remove the ingredients by tipping them out of the appliance or using tongs/silicone-tipped utensils. Do NOT place the baskets on top of the appliance.

REHEAT/WARM-UP

1-Place a hot air plate in a basket, add the ingredients and insert the basket into the appliance.

2-Select Zone 1 (you can also select Zone 2). Press the button to select "Reheat." The default temperature and time will appear on the LED display. Press the or button, then the or button to adjust the time and temperature.

3-Press the button to start cooking.

4-Halfway through the heating time, a beep will sound to remind you to turn the food. You can remove the basket and turn the ingredients.

5-When cooking is complete, a beep will sound.

6-Remove the ingredients by tipping them out of the appliance or using tongs/silicone-tipped utensils. Do NOT place the baskets on top of the appliance.

BAKE

1- Place a hot air plate in a basket, add the ingredients and insert the basket into the appliance.

2-Select Zone 1 (you can also select Zone 2). Press the button to select "Bake." The default temperature and time will appear on the LED display. Press the or button, then the or button to adjust the time and temperature.

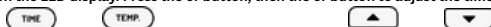

3- Press the button to start cooking.



4- Halfway through the cooking time, a beep will sound to remind you to remove the basket and shake or turn the ingredients.

5- When the cooking process is complete, a beep will sound.

6- Remove the ingredients by pouring them out or using tongs/silicone-tipped utensils. Do NOT place the baskets on top of the appliance.

DEHYDRATE / THE DOOR

1- Place a hot air plate in a basket, add the ingredients and insert the basket into the appliance.

2-Select Zone 1 (you can also select Zone 2). Press the button to select "Dehydrate." The default temperature and time will appear on the LED display. Press the or button, then the or button to adjust the time and temperature.



3- Press the button to start cooking.



4- Halfway through the cooking time, a beep will sound to remind you to remove the basket and shake or turn the ingredients.

5- When the cooking process is complete, a beep will sound.

6- Remove the ingredients by pouring them out or using tongs/silicone-tipped utensils. Do NOT place the baskets on top of the appliance.

CLEANING & CARE

- The device should be thoroughly cleaned after each use. Unplug the power cord and wait until it has cooled down completely before cleaning.

Main unit

- Wipe the main unit and control panel with a damp cloth.

- NOTE: NEVER immerse the main unit in water or any other liquid. NEVER clean the main unit in the dishwasher.**

Baskets/ hot air plate

- These can be handwashed. After washing, air dry all parts or dry them with a towel.
- If food residue sticks to the baskets, hot air plate, or racks, place them in a sink with warm soapy water and let them soak before washing.

HELPFUL TIPS

- For even browning, ensure the ingredients are evenly distributed across the bottom of the basket without overlapping. If any ingredients overlap, shake them halfway through the set cooking time.
- Cooking temperature and time can be adjusted at any time during the cooking process. Simply select the desired zone, press the TIME/TEMP button, and adjust the desired setting using the dial.
- To adapt recipes for conventional ovens, reduce the temperature by 25°C. Check the food regularly to avoid overcooking.
- Occasionally, the air fryer's fan will blow light foods around. Secure these with toothpicks (e.g., the top slice of bread from a sandwich).
- After selecting a cooking function, press the START/PAUSE button to begin cooking immediately. The appliance will operate at the preset temperature and time.
- For best results with fresh vegetables and potatoes, use at least 1 tablespoon of oil. Add more oil to achieve your desired crispiness.
- For best results, check the cooking process during the cooking process and only remove the food when the desired browning is achieved. We recommend using an instant-read thermometer to monitor the internal temperature of meat and fish.
- To avoid overcooking, remove the food immediately after the cooking time has ended.

TROUBLESHOOTING GUIDE

How do I set the temperature or time if I'm only using one zone?

TIME

TEMP



- Press the or button and then the or button to set the time and temperature.

- Can I prepare different foods in each zone without worrying about cross-contamination?**

Yes, both zones are self-contained and have separate heating elements and fans.

- How do I pause the countdown timer?**

- How do I stop cooking in one zone when using both zones?**

The countdown timer will automatically pause when you remove a basket from the appliance. Reinsert the basket within 10 minutes to resume cooking. Otherwise, cooking will stop in the zone where the basket is not present.

First, press the button for the respective zone, then press START/PAUSE. To stop both zones, simply press START/PAUSE.

- Can I safely place the baskets on the countertop?**

The baskets heat up during cooking, so handle them carefully. Only place them on heat-resistant surfaces.

- When should I use the hot air plate(s)?**

Use the convection plate if you want crispy food. The plates raise the food in the baskets, allowing air to flow under and around the ingredients to cook evenly and crisp them up.

- Why is my food not fully cooked?**

Ensure the basket is fully inserted during cooking. For even browning, ensure the ingredients are arranged evenly and without overlapping. Shake the basket to mix the ingredients for even crisping. The cooking temperature and time can be adjusted at any time during cooking if you want to increase the temperature or cook the food for longer.

- Why is my food burnt?**

For optimal results, check the cooking process and remove the food as soon as the desired degree of browning is reached. To avoid overcooking, remove the food immediately after the cooking time has elapsed.

- Why do some ingredients fly around when frying in the air fryer?**

Occasionally, the air fryer's fan will blow light foods around. Use wooden toothpicks to hold loose, light foods, such as the top slice of bread from a sandwich, in place.

- Can I deep fry moist, breaded ingredients?**

Yes, but use the correct breading technique. It's important to coat the food first with flour, then with egg, and finally with breadcrumbs. Press the breadcrumbs firmly onto the breaded ingredients to prevent the crumbs from being blown away by the fan.

- Why is the device beeping?**

Either the cooking time has elapsed or the other zone has started cooking (when using the Smart Finish function).

- Why did the screen go black?**

The device is in standby mode. Press the power button to turn the device back on.

- Why does the message "E" appear on the display?**

The device is not working properly.

- Why does the message "E7" appear on the display?**

The unit is overheating because it's in a corner or tight space. The unit requires at least 6 inches of space on the top and sides for air circulation. Turn off and unplug the unit to return it to normal operation. Let it cool for 30 minutes, then place it in a location with 6 inches of space on the top and sides. Also, make sure there are no other heat sources near the unit.

KEEP THESE INSTRUCTIONS!

Refer to them frequently and use them to instruct others.